

SERVO MOTOR - 089UDA300BARAA100140-JSHJ

089UDA300BARAA100140-JSHJ
HIGH INERTIA HD MOTOR



Definition

Type	Unimotor HD	
Frame Size (mm)	089	
Voltage	U	400 V
Magnet type	D	High Dynamic
Frame Length	A	
Speed (min ⁻¹)	30	3000
Brake	0	Unbraked
Connection type	B	Power and Signal 90° rotatable (Size 1)
Output shaft	A	With Key
Feedback device code	RA	Optical Hiperface SinCos Multi turn SRM50
Inertia & thermistor	A-JSHJ	High inertia + PTC thermistor
PCD	100	100 (FF 100 / 80)
Shaft Diameter	140	14j6 x 30.0
Fan Box	-	
Insulation class	F	
UL Motor / UL Stator	UL Motor / UL Stator	

Nominal characteristics

Motor Ambient Temperature (°C)	40	Drive Fsw (kHz)	12
Motor Stall Torque (N.m)	3.2	Stall Current (A)	2.0
Rated Torque (N.m)	3.0	Nominal Current (A)	1.88
Motor Peak Torque (N.m)	9.6	Kt (Nm/A)	1.6
Rated Power (kW)	0.9	Ke (V/kmin ⁻¹)	98.0
Winding Thermal Time Constant (s)	85	R (ph-ph) (Ohm)	10.8
Number of Poles	10	L (ph-ph) (mH)	66.8
Typical Cogging (N.m)	0.05		
Inertia (kg.cm ²)	3.2	Weight (kg)	4.1
Ingress Protection Level (IP)	IP65		

Torque / speed graph

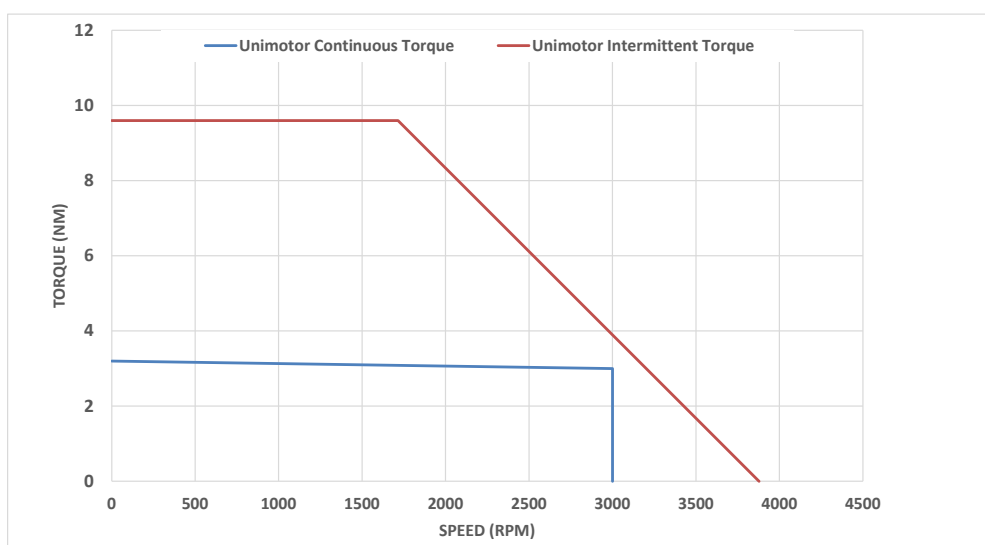

SERVO MOTOR - 089UDA300BARAA100140-JSHJ

Motors (° & mm)

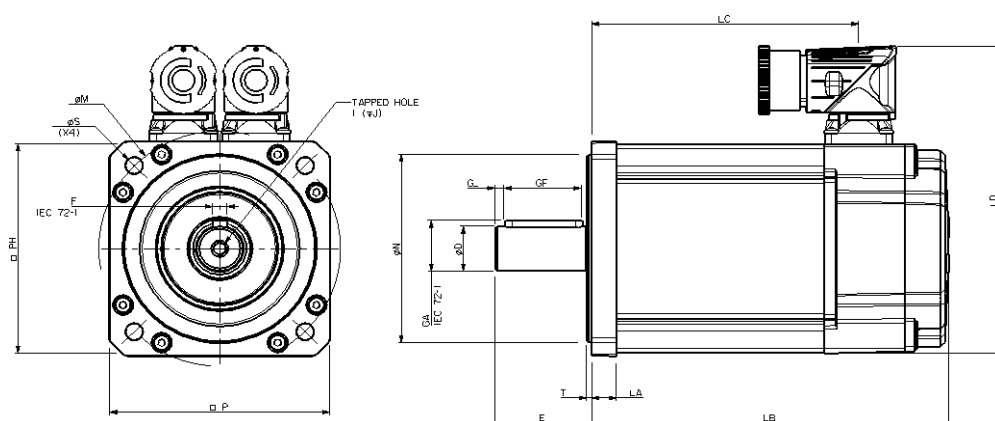

LB	Total length	190.8
LC	Connector position	140.5
LA	Flange thickness	10.3
T	Register Length	2.2
N	Register Diameter	80.0
LD	Connector overall height	130.5
P	Flange Square	91.0
S	Fixing Hole Diameter	7.0
M	Fixing hole PCD	100.0
PH	Motor Housing Width	89.0
D	Shaft Diameter	14j6
E	Shaft Length	30.0
GA	Key Height	16.0
GF	Key Length	25.0
G	Key to Shaft End	1.5
F	Key Width	5.0
I	Tapped Hole Thread Size	M5 x 0.8
J	Tapped Hole Depth	13.5
	Mounting Bolt	M6

Motor electrical interface Connectors option:

Feedback device code: RA - Optical Hiperface SinCos Multi turn SRM50

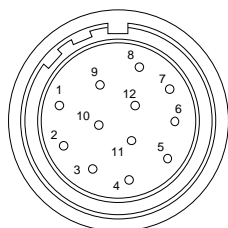

Pin out	Function	Pin out	Function
1	Cos -	10	0 v
2	Data +	11	-
3	Data -	12	Screen + 8 VDC
4	Cos +	Body	Screen
5	Sin +		
6	Sin -		
7	Thermistor +		
8	Thermistor -		
9	Screen		

Connection type: B - Power and Signal 90° rotatable (Size 1)

