

SERVO MOTOR 142UDA300BACAA165240-JSHJ

142UDA300BACAA165240-JSHJ HIGH INERTIA MOTOR



Definition

| Type | Unimotor HD | |
|----------------------|----------------------|---|
| Frame Size (mm) | 142 | |
| Voltage | U | 400 V |
| Magnet type | D | High Dynamic |
| Frame Length | A | |
| Speed (min-1) | 30 | 3000 |
| Brake | 0 | Unbraked |
| Connection type | B | Power and Signal 90° rotatable (size 1) |
| Output shaft | A | With output key |
| Feedback device code | CA | Incremental encoder 4096 ppr (CF550) |
| Inertia & thermistor | A-JSHJ | High inertia + PTC thermistor |
| PCD | 165 | 165 (FF 165/130) |
| Shaft Diameter | 240 | 24j6 x 50.0 |
| Fan Box | - | |
| Insulation class | F | |
| UL Motor / UL Stator | UL Motor / UL Stator | |

Nominal characteristics

| | | | |
|-----------------------------------|------|---------------------|------|
| Motor Ambient Temperature (°C) | 40 | Drive Fsw (kHz) | 12 |
| Motor Stall Torque (Nm) | 10.1 | Stall Current (A) | 6.0 |
| Rated Torque (Nm) | 8.2 | Nominal Current (A) | 5.1 |
| Motor Peak Torque (Nm) | 30.3 | Kt (Nm/A) | 1.6 |
| Rated Power (kW) | 2.6 | Ke (V/kmin-1) | 98.0 |
| Winding Thermal Time Constant (s) | 235 | R (ph-ph) (Ohm) | 1.5 |
| Number of Poles | 10 | L (ph-ph) (mH) | 18.1 |
| Maximum Cogging (Nm) | 0.15 | | |
| Inertia (kg.cm²) | 23.4 | Weight (kg) | 10.9 |
| Ingress Protection Level (IP) | IP65 | | |

Torque / speed graph

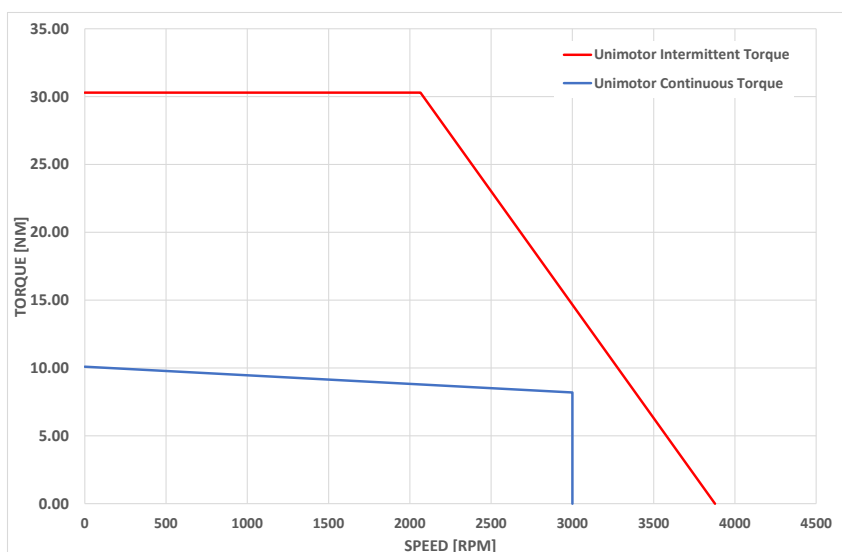

SERVO MOTOR 142UDA300BACAA165240-JSHJ

Motors (° & mm)

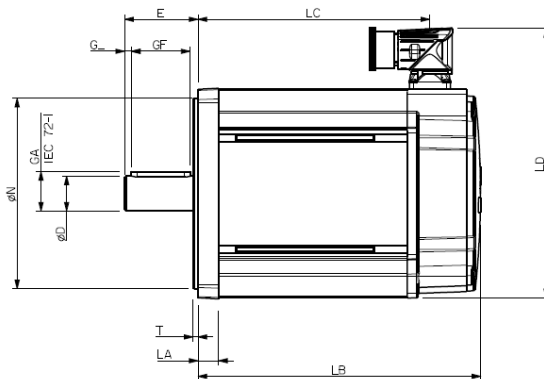
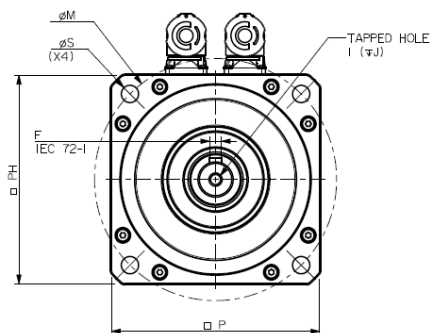

| | | |
|----|--------------------------|-----------|
| LB | Total length | 187.0 |
| LC | Power connector position | 152.5 |
| LA | Flange thickness | 14.0 |
| T | Register Length | 3.4 |
| N | Register Diameter | 130.0 |
| LD | Connector overall height | 183.5 |
| P | Flange Square | 142.0 |
| S | Fixing Hole Diameter | 12.0 |
| M | Fixing hole PCD | 165.0 |
| PH | Motor Housing Width | 142.0 |
| D | Shaft Diameter | 24j6 |
| E | Shaft Length | 50.0 |
| GA | Key Height | 27.0 |
| GF | Key Length | 40.0 |
| G | Key to Shaft End | 4.6 |
| F | Key Width | 8.0 |
| I | Tapped Hole Thread Size | M8 x 1.25 |
| J | Tapped Hole Depth | 20.0 |
| | Mounting Bolt | M10 |

NOTE: MOTOR END FRAMES, HOUSING AND REAR COVER PAINTED BLACK

Motor electrical interface Connectors option:

Feedback device code: CA - Incremental encoder 4096 ppr (CF550)

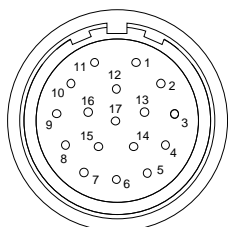

- | | |
|----------------|------------------------|
| 1 - Thermistor | 10 - CHANNEL A |
| 2 - Thermistor | 11 - INDEX |
| 3 - - | 12 - INDEX REVERSE |
| 4 - S1 | 13 - CHANNEL A INVERSE |
| 5 - S1 INVERSE | 14 - CHANNEL B |
| 6 - S2 | 15 - CHANNEL B INVERSE |
| 7 - S2 INVERSE | 16 - +V |
| 8 - S3 | 17 - 0V |
| 9 - S3 INVERSE | BODY - SCREEN |

Connection type: B - Power and Signal 90° rotatable (size 1)

