

# INSTALLATION INSTRUCTIONS

## MULTI-DRIVE FORWARD-BRAKE-REVERSE SWITCH (KB P/N 9860)

(Tools Required: 1/4" Flat Blade Screwdriver, Long Nose Pliers, 9/16" Nut Driver)

1. Remove (2) 6-32 front screws and slide off front cover of MULTI-DRIVE™
2. Remove hole plug from front panel.
3. Remove hex nut from FWD-BRK-REV switch. **Use this nut to install switch.**

*Note: An additional nut (identical to the one supplied on the switch) is enclosed in the hardware bag in the event the original is misplaced.*

4. Slide FWD-BRK-REV switch assembly into front panel. Install with 15/32" hex nut (supplied). Tighten assembly with 9/16" nut driver. (See fig. 1a, b & c) (Do not overtighten nut or threads will strip.)

### LEFT SIDE VIEW OF MULTI-DRIVE

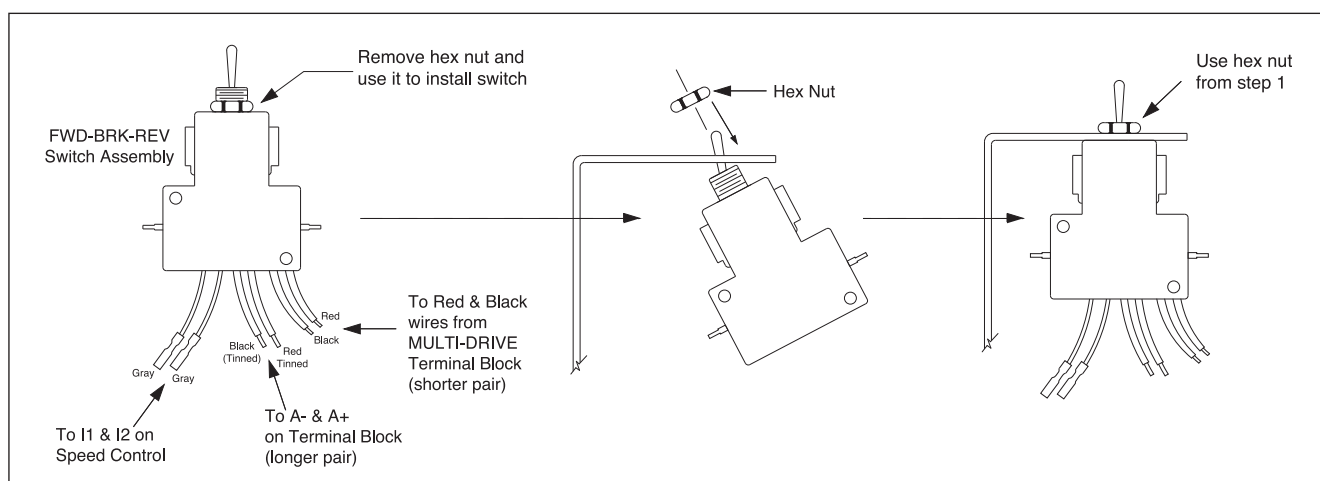

5. Remove red and black leads from terminal block of control (A- and A+). Connect these leads to the shorter pair of red and black wires from the FWD-BRK-REV switch assembly. Be sure to connect red wire to red wire and black wire to black wire. Use two (2) wire connectors (provided).
6. Connect the other pair of red/black tinned leads back to terminal block of control (black to A-, red to A+)
7. Install two (2) gray wires from FWD-BRK-REV switch assembly (wires are terminated with P/N 2-520272-2 Amp, .110 insulated Q-D fast-ons) to the I1 and I2 terminals of the speed control using long nose pliers. (Note: I1 and I2 are located at the top right and bottom right side of MIN trimpot.)
8. Place FWD-BRK-REV switch in FWD position. Installation is now complete.

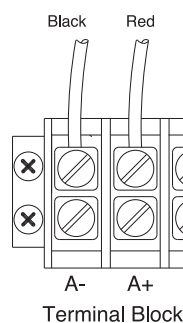

Use screwdriver to remove these wires from Terminal Block and connect to shorter pair of Red & Black wires from FWD-BRK-REV Switch

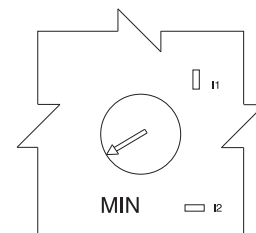

Position of I1 & I2 terminals of Speed Control

**WARNING! Allow Motor To Stop Before Reversing.**



"The Right Control  
for Your Application"

KB ELECTRONICS, INC.  
12095 NW 39th Street, Coral Springs, FL 33065-2516 • (954) 346-4900 • (954) 346-3377  
Outside Florida Call **TOLL FREE** (800) 221-6570 • E-mail – info@kbelectronics.com  
www.kbelectronics.com

(A40030) – Rev. C – 4/2000