

The 5200D series is a precision permanent magnet DC, brush commutated motor that can be mounted to a variety of Merkle-Korff gear reducer options. The 5200D series motor can be paired with a KB Electronics SCR or PWM Drive for speed control.

### SPECIFICATIONS

**Input Voltage:** 12 to 150 Vdc  
**Output Power:** 25 to 60 Watts  
**Rotation:** Bi-Directional  
**Maximum Speed:** 6000 RPM  
**Temperature Range:** -30 °C to +80 °C

### Construction Features

**Poles:** 2  
**Bearings:** Ball  
**Brushes:** Long life copper or silver graphite  
**Insulation Class:** F  
**Windings:** Trickle Resin Impregnated  
**Armature:** Dynamically balanced for low vibration  
**Shaft Diameters:** 8mm  
**Termination:** #18 AWG Lead Wires  
**Regulatory Approvals:** UL, CE, RoHs

### TYPICAL APPLICATIONS

- Analytical Laboratory Equipment
- Food Service Equipment
- Actuators
- Pumps
- Conveyors
- Material Handling
- Packaging equipment
- Automatic Door Operators

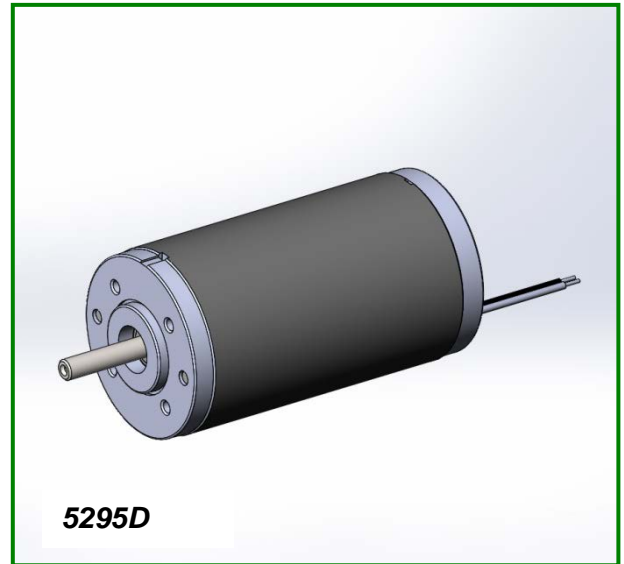

### OPTIONAL FEATURES

- Customized output shafts including dual output
- Various lead lengths, terminals and connectors
- Brakes: Electromagnetic
- EMI Filtering: Internal Suppression
- Magnetic Encoder: 2 to 12 PPR Resolution
- Optical or Capacitive: Up to 2048 PPR Resolution

5200D

**MOUNTING**

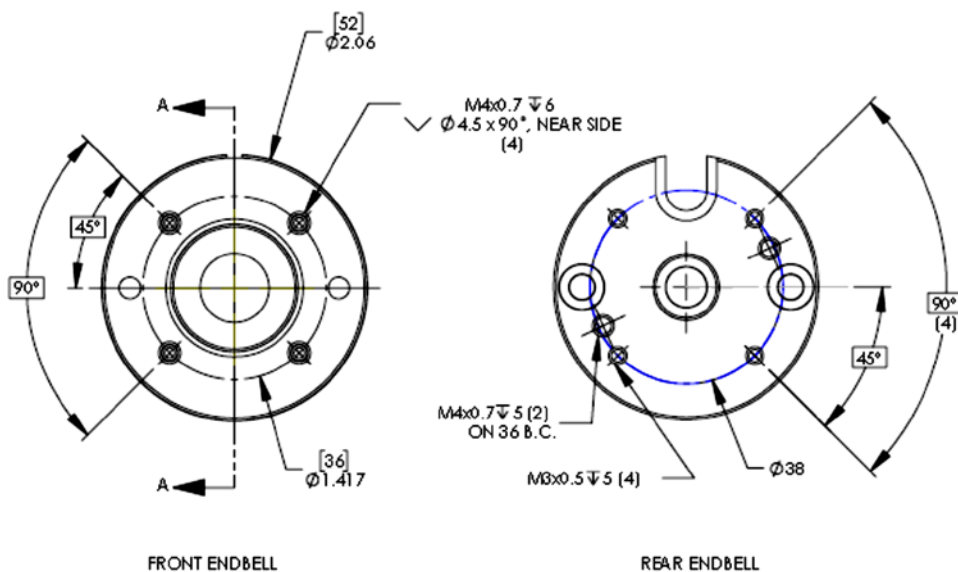

**5200D**

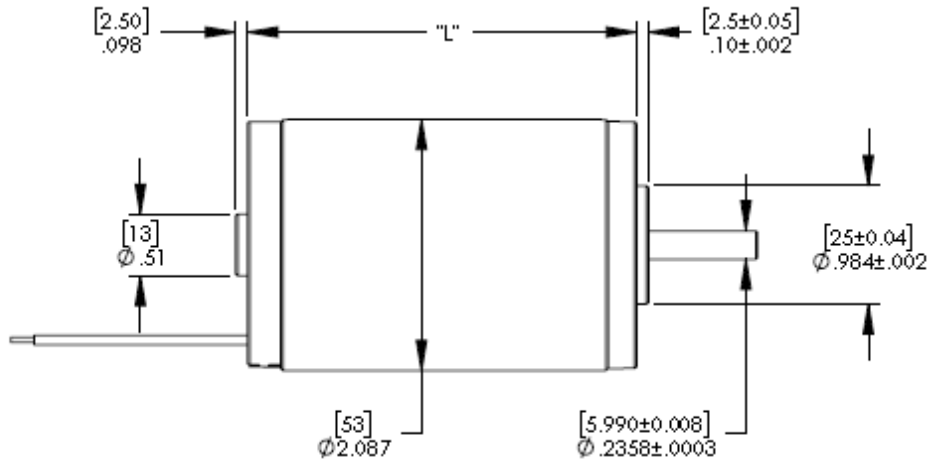

MOTOR	DIM "A"
5275D	3.27 [B3]
5295D	3.82 [P7]
52125D	5.00 [127]

**5200D SERIES MOTOR PERFORMANCE**

Parameter	Symbol	Units	5275D	5275D	5295D	5295D	52125D	52125D
Voltage	E	Volts	24	60	24	60	24	60
Continuous Torque	T <sub>c</sub>	N.m	0.075	0.075	0.10	0.10	0.17	0.17
Continuous Current	I	Amps	1.6	0.62	2.3	0.9	2.9	1.3
Continuous Speed	n <sub>c</sub>	RPM	3300	3400	3600	4000	2850	3100
Stall Torque	T <sub>s</sub>	N.m	0.38	0.38	0.67	0.67	1.4	1.4
No Load Speed	N <sub>0</sub>	RPM	4130	4300	4200	4500	3300	3600
Output Power	P	Watts	25	25	40	40	60	60
No Load Current	I <sub>0</sub>	Amps	0.17	0.07	0.28	0.12	0.2	0.1
Maximum Winding Temperature	Θ <sub>max</sub>	°C	155	155	155	155	155	155
Torque Constant	K <sub>t</sub>	N.m/Amp	0.051	0.126	0.051	0.128	0.063	0.142
Back-EMF Constant	K <sub>e</sub>	V.s/rad	0.051	0.126	0.051	0.128	0.063	0.142
Length	L	mm	75	75	95	95	125	125