

Compact, quiet and versatile, the KF Series is ideal when space is a premium. A variety of features and gear reductions enable custom design and low life-cycle costs.

SPECIFICATIONS & CONSTRUCTION

Type: Zinc die cast AC gearmotor
Output speeds: 50 to 400 RPM
Voltage: 24V to 230V, 50 or 60 Hz
Bearings: Self-aligning sintered bronze
Termination: Spade terminals or lead wires
Protection: Impedance or thermally protected
Duty Cycle: Intermittent
Motors Available: 3400, 3700, 4400, 4500
Rotation: Unidirectional; PSC-Reversing (KFS)
Cover: Die cast or Stamped Steel
Lubrication: Synthetic Grease
Regulatory Approvals: UL, CSA, CE, RoHs

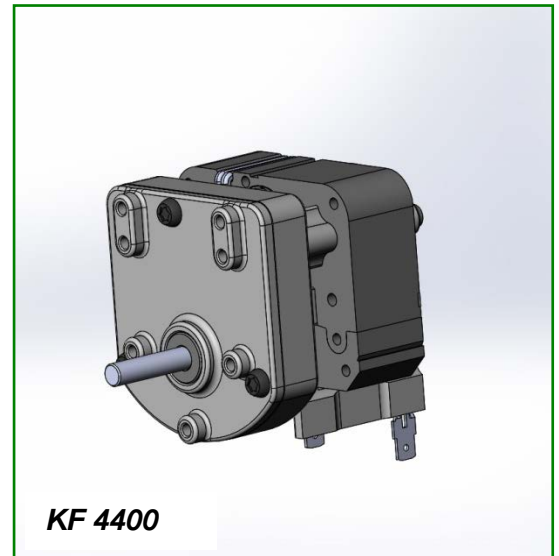

TYPICAL APPLICATIONS

- Office Equipment
- Laminators
- Displays
- Ingredient Dispenser
- Food Service Equipment
- Pumps

Maximum Permissible Torque: 30 In.Lb (3.4 Nm)
Speed: Up to 400 RPM

Note: Speed and torque combinations will vary depending on the motor/gearbox combination.

OPTIONAL FEATURES

- Customized output shafts including dual output
- Various lead lengths, terminals and connectors
- Brakes: Positive-Stop, Cone, Coil Spring
- Output Needle bearings for high radial loads
- Ball bearing for motor
- Fan for additional cooling

MOUNTING

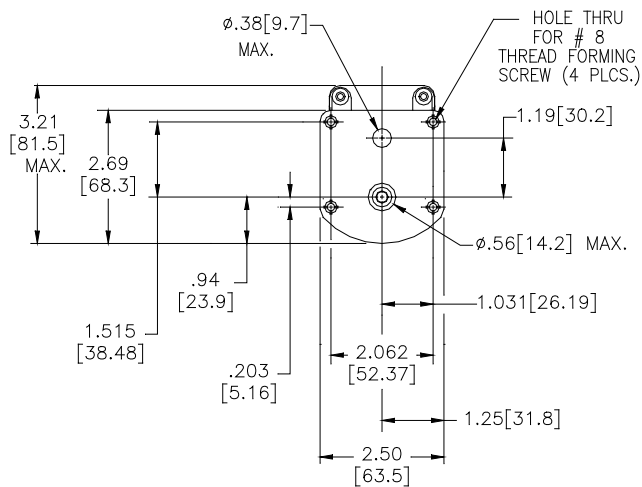

STAMPED STEEL COVER

MOUNTING

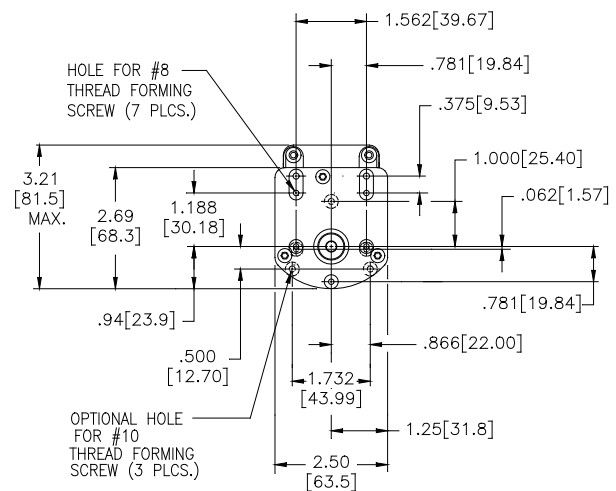

DIE-CAST COVER

KF3700

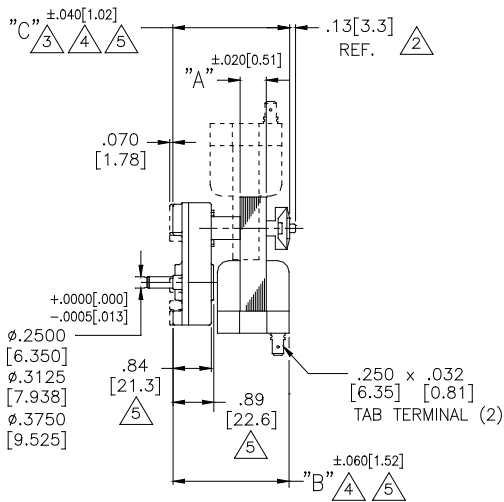

STATOR SIZE	"A" DIM	"B" DIM	"C" DIM
3709	.575[14.61]	2.561[65.05]	2.528[64.21]
3715	.937[23.80]	2.923[74.24]	2.890[73.41]
3720	1.250[31.75]	3.236[82.19]	3.203[81.36]
3724	1.500[38.10]	3.486[88.54]	3.453[87.71]
3728	1.760[44.70]	3.746[95.15]	3.713[94.31]
3732	2.000[50.80]	3.986[101.24]	3.953[100.41]

NOTES:

- BROKEN LINES REPRESENT OPTIONAL MOUNTINGS.
- FOR FAN APPLICATION, ADD $.600$ [15.24] TO DIMENSION. FOR COIL SPRING BRAKE APPLICATION, ADD $.600$ [1.52] TO DIMENSION.
- FOR COIL SPRING BRAKE APPLICATION, ADD $.188$ [4.78] TO "C" DIMENSION.
- FOR LONG MOUNTING APPLICATION, SUBTRACT $.185$ [4.70] FROM "B" & "C" DIMENSION.
- FOR STAMPED COVER APPLICATION, SUBTRACT $.289$ [7.34] FROM DIMENSIONS.

KF4500

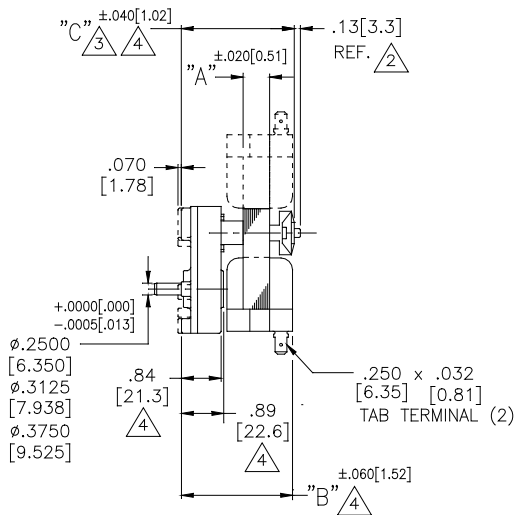

STATOR SIZE	"A" DIM	"B" DIM	"C" DIM
4506	.375[9.53]	2.191[55.65]	2.168[55.07]
4509	.562[14.27]	2.378[60.40]	2.355[59.87]
4512	.733[18.62]	2.549[64.74]	2.526[64.16]
4515	.937[23.80]	2.753[69.93]	2.730[69.34]
4520	1.275[32.39]	3.091[78.51]	3.068[77.93]
4526	1.625[41.28]	3.441[87.40]	3.418[86.82]

NOTES:

- BROKEN LINES REPRESENT OPTIONAL MOUNTINGS.
- FOR FAN APPLICATION, ADD $.600$ [15.24] TO DIMENSION. FOR COIL SPRING BRAKE APPLICATION, ADD $.600$ [1.52] TO DIMENSION.
- FOR COIL SPRING BRAKE APPLICATION, ADD $.188$ [4.78] TO "C" DIMENSION.
- FOR STAMPED COVER APPLICATION, SUBTRACT $.289$ [7.34] FROM DIMENSIONS.



KFS3400

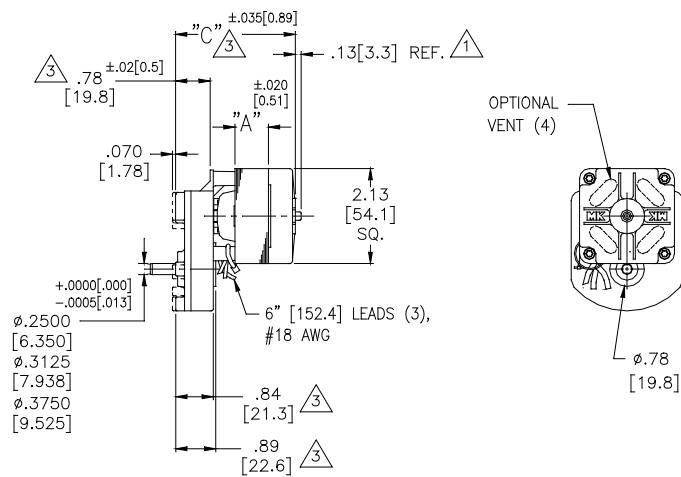

STATOR SIZE	"A" DIM	"C" DIM
3410	.625 [15.88]	2.552 [64.82]
3420	1.250 [31.75]	3.177 [80.70]
3424	1.500 [38.10]	3.427 [87.05]

NOTES:

- 1 FOR FAN APPLICATION, ADD .600 [15.24] TO DIMENSION.
FOR BRAKE APPLICATION, ADD .09 [2.3] TO DIMENSION.
- 2. BROKEN LINES REPRESENT OPTIONAL MOUNTINGS.
- 3 FOR STAMPED COVER APPLICATION, SUBTRACT .289 [7.34] FROM DIMENSIONS.