

ECOAPEX™ 48 EC Heat Pump Fan Motor

High Efficiency ECM for Residential & Commercial Pool or Spa Heat Pumps



- Robust EC motor designed specifically for outdoor heat pump applications
- Multiple mounting positions to fit a wide range of evaporative designs
- ECM efficiency supports higher coefficient of performance (COP) levels meaning more energy efficient heat pumps
- Utilizes conventional 48 frame mounting configurations
- Variable speed motor provides the ability to optimize the heat pump's performance for each pool's unique demands
- Quiet operation



Product Overview

Designed to stand up to the harsh environment and temperatures found in outdoor pool heat pumps, the ECOAPEX™ 48 EC heat pump fan motor provides the efficiency required for high COP rated systems in a robust package. Able to operate at two programmable speeds or fully variable, the ECOAPEX™ 48 motor provides precise control in water heating.

Key Features and Benefits

- PWM (Pulse Width Modulation) control signal provides full airflow modulation
- Three discrete speeds using the 2–24V speed taps
- TEAO motor can be mounted at any angle
- High 60°C max ambient operating temperature

Specifications

Horsepower: 1/3 HP

Voltage: 1Ø, 208 - 230 Volts

Speeds: 300 - 1200 RPM

Inputs: PWM, 2 - 24V Speed Taps

Operation Modes: Constant Speed

Frame: NEMA®† 48

Enclosure: Totally Enclosed Air Over (TEAO)

Efficiency: Up to 75%

Mounting: Belly-band, Stud Mount, Shaft Up or Shaft Down Orientation



Dimension Print

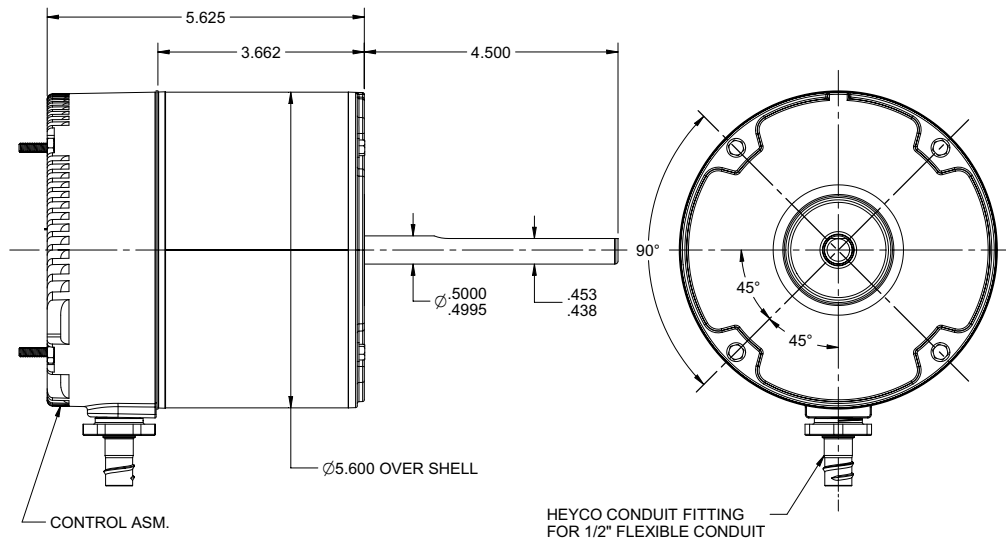

† All marks shown within this document are properties of their respective owners.

Nidec Motor Corporation, 2014; All Rights Reserved. U.S. MOTORS® is a registered trademark of Nidec Motor Corporation.
Nidec Motor Corporation trademarks followed by the ® symbol are registered with the U.S. Patent and Trademark Office.

Nidec
NIDEC MOTOR CORPORATION

8050 W. Florissant Avenue | St. Louis, MO 63136
Phone: 888-637-7333 | Fax: 866-422-7758